

28mm double glazed unit comprising of:  
4mm clear toughened solar control outer pane,  
20mm Argon filled cavity,  
4mm clear toughened low 'e' inner pane

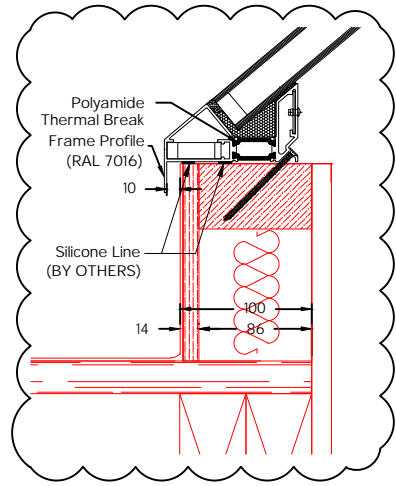

**Key:**

— by others

— by EOS

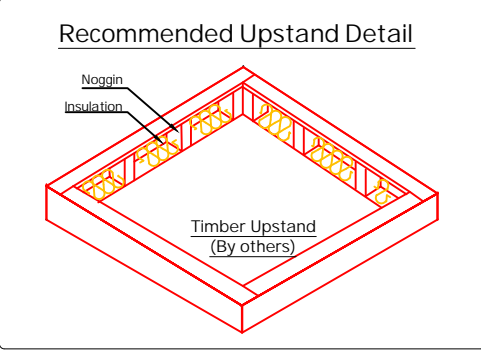

Title: Double Glazed Frameless Lantern Rooflight (For Builders Upstand)

System: Lantern

Size: Bespoke

Type: Fixed

Ref:



Scale: 1:8 @ A3

Date: March 21

0 revision

EOS Rooflights, The Beechwood Centre, 42-46 Lower Gravel Road, Bromley, Kent, BR2 8GP [info@eosrooflights.co.uk](mailto:info@eosrooflights.co.uk) [www.eosrooflights.co.uk](http://www.eosrooflights.co.uk)

This drawing is copyright and may not be reproduced either in part or full without written permission from EOS Rooflight's. **DO NOT SCALE OFF THIS DRAWING**